

RADIX® FIBER POST

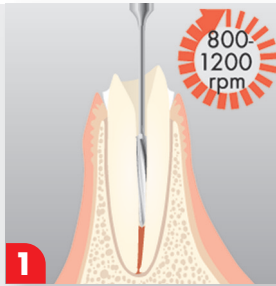

Mix XP BOND with SCA.



1 Use Largo® Peeso Reamer to remove root canal filling material

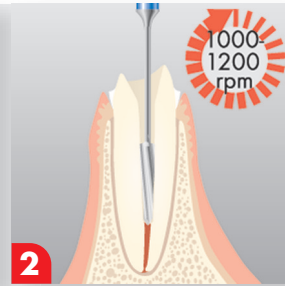

2 Prepare canal with Radix® Fiber Post Precision Drill

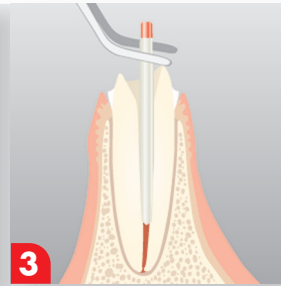

3 Check fit of Radix® Fiber Post

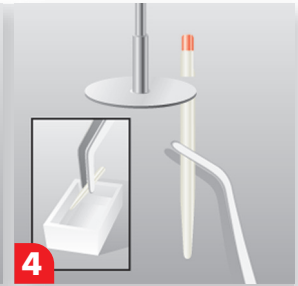

4 Reduce Radix® Fiber Post to adequate length and clean with alcohol

1 Light-cure XP BOND :
≥ 550 mW/cm² = 20 sec

2 Please follow manufacturer's directions

3 Light-cure Core • X™
in 2 mm increments
≥ 500 mW/cm² = 10 sec
in 3 mm increments
≥ 500 mW/cm² = 30 sec
≥ 800 mW/cm² = 20 sec

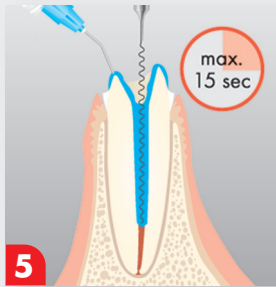

5 Etch dentin with DeTrey® Conditioner 36

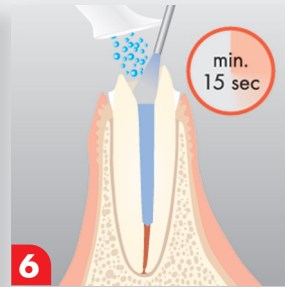

6 Remove acid gel and rinse



7 Remove surplus of water with paper points and/or air. Do not desiccate!

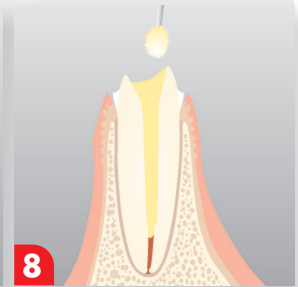

8 Apply XP Bond/SCA into canal or prime & bond

RADIX® FIBER POST

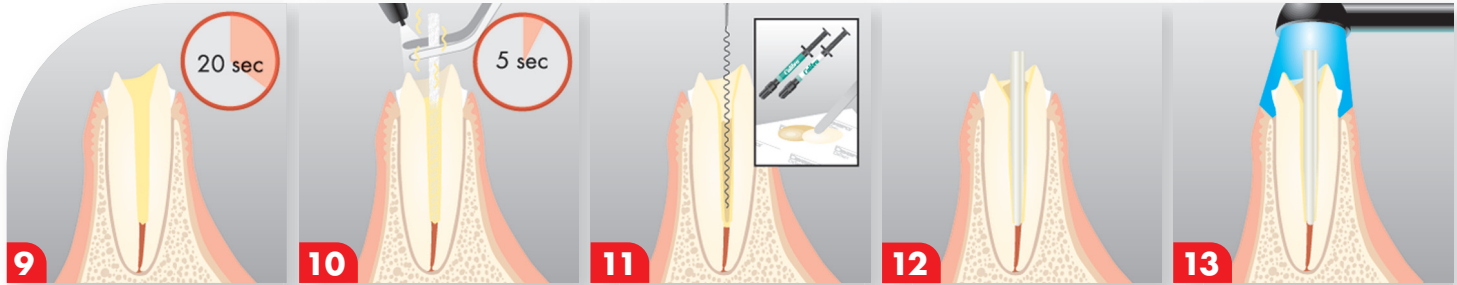

9 Leave XP BOND/SCA undisturbed

10 Remove surplus of XP BOND/SCA with paper points. Evaporate solvent by blowing gently with air

11 Mix Calibra® Base and Catalyst paste. Apply Calibra into canal.

12 Seat Radix® Fiber Post. Clean up excess

13 Light-cure accessible area ¹



14 Rebuild core with core-build-up composite, e.g. Core • X™ 2-3

Preparation of post

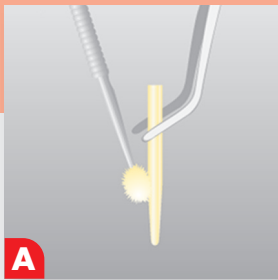

A Wet the whole Radix® Fiber Post with XP BOND/SCA ore prime & bond

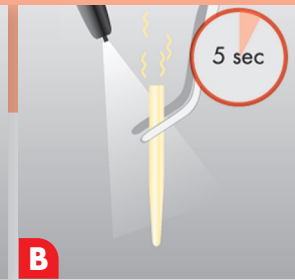

B Air dry XP Bond/SCA by blowing gently with air